

PRODUCT ID: 32647

Switch

MODEL

SWP6 111111

DIMENSIONS

4.5" H x 11.93" W x 1" D (est. 0.451 lbs)

CONSTRUCTION

Finish: Switch plate brushed stainless steel

Switch: Switch with pre-wired pigtails and indicator lights

Switch plate: Stamped stainless steel pre-punched for switch(es) and indicator light(s)

ELECTRICAL

Input Voltage: 120VAC

Product View

NOTE: Sign image may not exactly represent the finished product. For illustration purposes only.

Front View

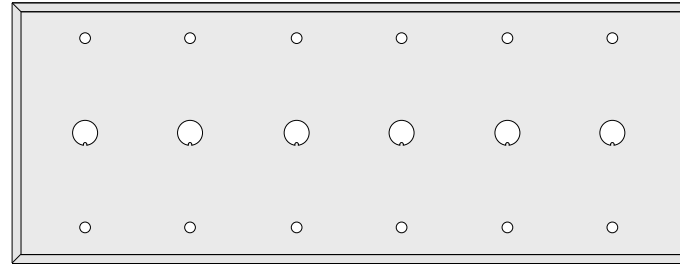

Six Gang Switch Plate

Dimensional View

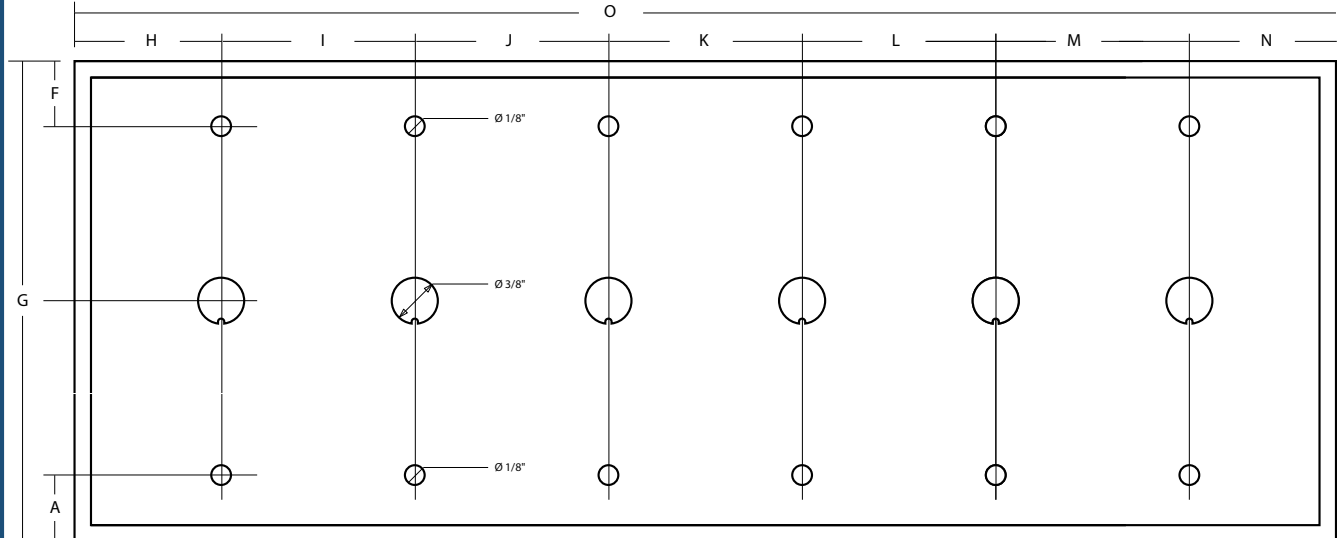

A
 $1/6"$

E
 $1/16"$

F
 $1/6"$

G
 $4 1/2"$

H
 $1 3/8"$

I
 $1 1/6"$

J
 $1 13/16"$

K
 $1 13/16"$

L
 $1 13/16"$

M
 $1 3/8"$

N
 $1 3/8"$

O
 $11.930"$

iSIGNS Inc.
7625 Birkmire Drive
Fairview, PA 16415
Phone: 866-437-3040
Website: www.isignsled.com



Proudly Made in the USA